

HALF STREET

AKRIDGE

RETAIL



FOR MORE INFORMATION GO TO
AKRIDGEHALFSTREET.COM
RETAIL LEASING INFORMATION CALL 301.652.9020



CAN YOU SPOT THE NEXT TREND?

- + **PEOPLE LIKE SHOPPING** It's simple – to find what's next, shoppers look for the best. They hit the streets and check out the big retailers, or browse the charming boutiques. Either way, they'll find what they like at Akridge at HALF STREET.
- + **SHOPPERS LIKE EATING** Nothing brings sports fans, couples, families and friends together like a romantic dinner, a taste of the good life or a victory toast.
- + **EVERYONE LIKES FUN** Baseball isn't the only game in town. People come to the Capitol Riverfront to see and be seen, dance, dine, have a drink and discover a new side of Half Street. Enjoy immediate Metro access, the expanded Riverwalk Trail, 5 parks, 2 museums and the National Mall just a few blocks away.

RETAIL LEASING OPPORTUNITIES AVAILABLE
301.652.9020 OR STREETSENSE.COM

streetsense

Akridge
Real Estate at the Highest Grade



IF 41,888 FANS WALK ON HALF STREET,
 & **HALF STREET** HAS 75,000 SQUARE FEET OF RETAIL SPACE,
**HOW MANY CUSTOMERS WILL YOU GET AT
 HALF STREET?**

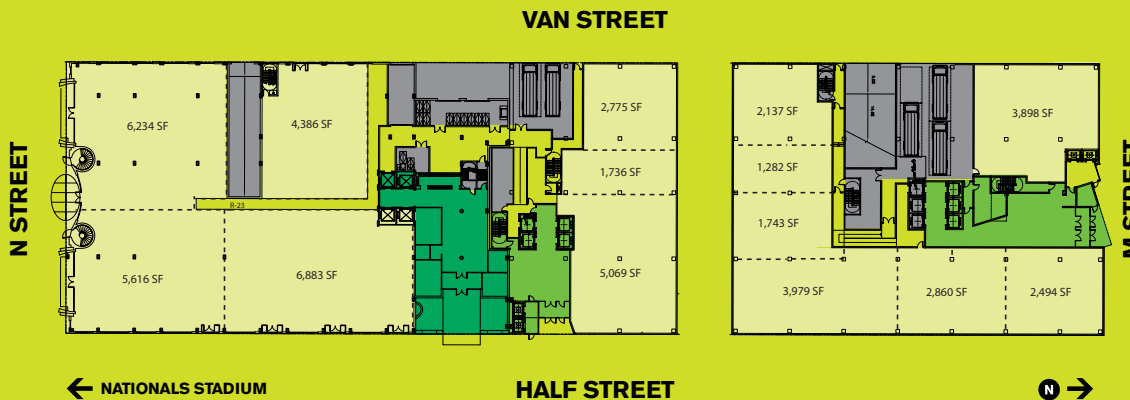

- Retail Spaces
- Office Lobby
- Residential Lobby

CAPITOL RIVERFRONT (EXISTING)

- + Total Development 9,370,000 square feet
- + Office 6,200,000 square feet
- + Retail 127,280 square feet
- + Residential Units 1,830 units
- + Hotel Rooms 204 rooms

CAPITOL RIVERFRONT (PROJECTED 2011)

- + Total Development 14,300,000 square feet
- + Office 8,800,000 square feet
- + Retail 450,000 square feet
- + Residential Units 4,000 units
- + Hotel Rooms 600 rooms

HALF STREET PROJECT

- + Total Development 1,500,000 square feet
- + Retail Development 125,000 square feet

AKRIDGE AT HALF STREET

- + Total Development 700,000 square feet
- + Retail Development 75,000 square feet

RETAIL LEASING OPPORTUNITIES AVAILABLE
 301.652.9020 OR STREETSSENSE.COM

